

Directional 900 NEMA

Installation Instructions

Part # = 3005-104

THE DIRECTIONAL 900 NEMA PROJECTS AN INVISIBLE BEAM UP TO 25 FEET ACROSS THE AREA YOU WISH TO BE COUNTED. THE INWARD AND OUTGOING COUNTS CAN BE VIEWED ON A COMPUTER USING THE OPTIONAL COMPUCOUNT DATA MANAGER.

CONTROLS AND FUNCTIONS

- (1) *SMART SWITCH* – PERFORMS COUNTER FUNCTIONS WHEN MAGNET HELD AT THIS X
- (2) *SIGNAL PORT* – MUST BE FACING EACH OTHER TO CREATE BEAM
- (3) *REMOVE THESE SCREWS TO ACCESS MOUNTING HOLES*
- (4) *RECEIVER COUNTER LED* – BLINKS WHEN FUNCTION OCCURS

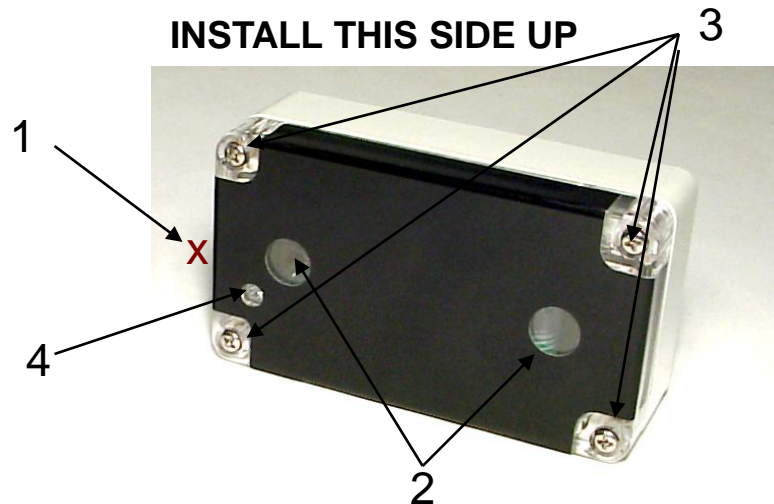

THE RECEIVER AND TRANSMITTER ARE SHIPPED IN THE INACTIVE MODE TO CONSERVE BATTERY LIFE AND ELIMINATE SIGNAL DURING SHIPMENT. TO ACTIVATE HOLD THE MAGNET AGAINST SMART SWITCH (1) UNTIL THE LED (4) GOES OUT, THEN QUICKLY RELEASE.

FOR PRELIMINARY PROOF OF OPERATION, PLACE THE COUNTERS ON A TABLE-TOP SEVERAL FEET APART AND INTERRUPT THE INVISIBLE BEAM WITH YOUR HAND. IF THE RECEIVER COUNTER LED (4) BLINKS, IT IS WORKING. ADD THE SENSOR TO THE COMPUCOUNT (SEE THE COMPUCOUNT MANUAL) BEFORE PHYSICALLY INSTALLING THE COUNTER.

1. FOR INSTALLATION, REMOVE THE BLACK COVER BY REMOVING THE FOUR SCREWS (3) AND FIND THE MOUNTING HOLES INSIDE THE BOX. THE COUNTERS SHOULD BE PLACED FACING EACH OTHER, WITH NO BEAMPATH OBSTRUCTIONS, APPROXIMATELY 35 INCHES HIGH FOR COUNTING BOTH ADULTS AND CHILDREN, AND 55 INCHES HIGH FOR COUNTING ADULTS ONLY.
2. INSTALL THE TRANSMITTER COUNTER FIRST, USING THE MOUNTING FLANGE (3). BEFORE PERMANENT INSTALLATION OF THE RECEIVER COUNTER, POSITION IT ON THE WALL OPPOSITE THE TRANSMITTER COUNTER AND PERFORM THE BLINK TEST AGAIN, AS STATED ABOVE. IF THE TEST IS SUCCESSFUL, PROCEED TO PERMANENT INSTALLATION.

Directional 900 NEMA

Battery Installation

Part # = 3005-104

BATTERY REPLACEMENT

TO ENSURE PROPER FUNCTION, BATTERIES MUST BE CHANGED AT RECOMMENDED INTERVALS. TO REPLACE THE BATTERIES IN EITHER COUNTER, REMOVE THE FOUR SCREWS (3), REMOVE THE COVERS FROM THE BACKPLATE, REMOVE THE OLD BATTERIES, AND REPLACE WITH NEW LITHIUM BATTERIES FROM WALKER WIRELESS. **DO NOT** ATTEMPT TO REPLACE WITH 1.5 VOLT AA BATTERIES.

INACTIVE MODE

SHOULD YOU EVER NEED TO PLACE THE COUNTER RECEIVER IN THE INACTIVE MODE, HOLD THE MAGNET AGAINST THE SMART SWITCH (1) FOR MORE THAN TEN SECONDS UNTIL THE LIGHT COMES ON. REMOVE THE MAGNET WHEN THE LIGHT COMES ON. TEST THAT THE UNIT IS OFF (INACTIVE) BY HOLDING THE MAGNET AGAINST THE SMART SWITCH FOR A FEW SECONDS. IF THE LED COMES ON, OR FLICKERS, THE UNIT IS OFF (INACTIVE).